

STAIR -1 PLAN
 (REF DWG:A601)
 NOTES:
 1. TOP OF STEEL ELEVATION = (12-6) U.N.O.
 2. (+/- X-X) = ABOVE/BELOW TOP OF STEEL ELEVATION.

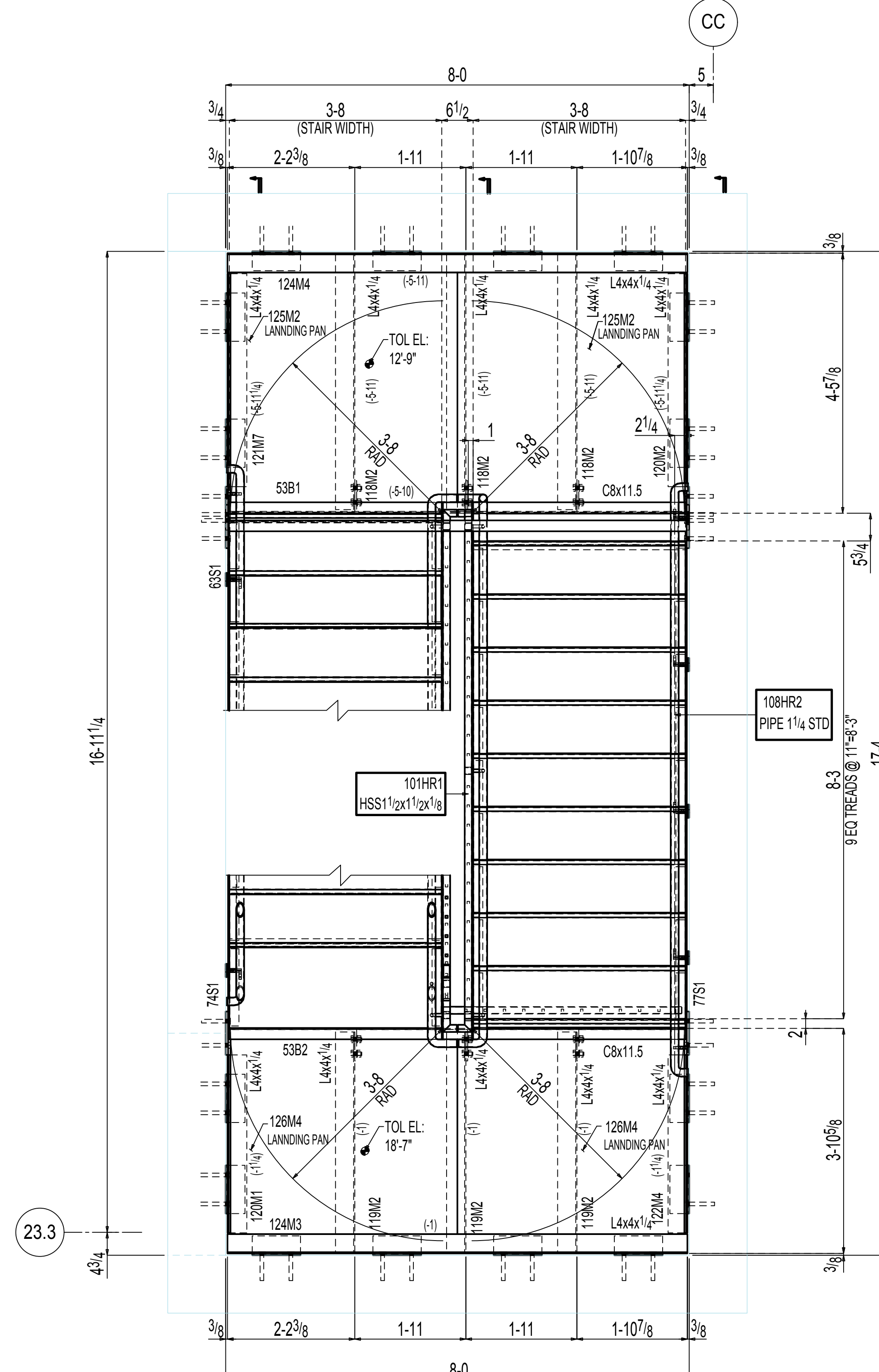

STAIR -1 PLAN
 (REF DWG:A601)
 NOTES:
 1. TOP OF STEEL ELEVATION = (18-4) U.N.O.
 2. (+/- X-X) = ABOVE/BELOW TOP OF STEEL ELEVATION.

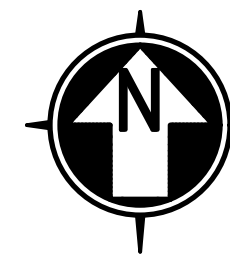
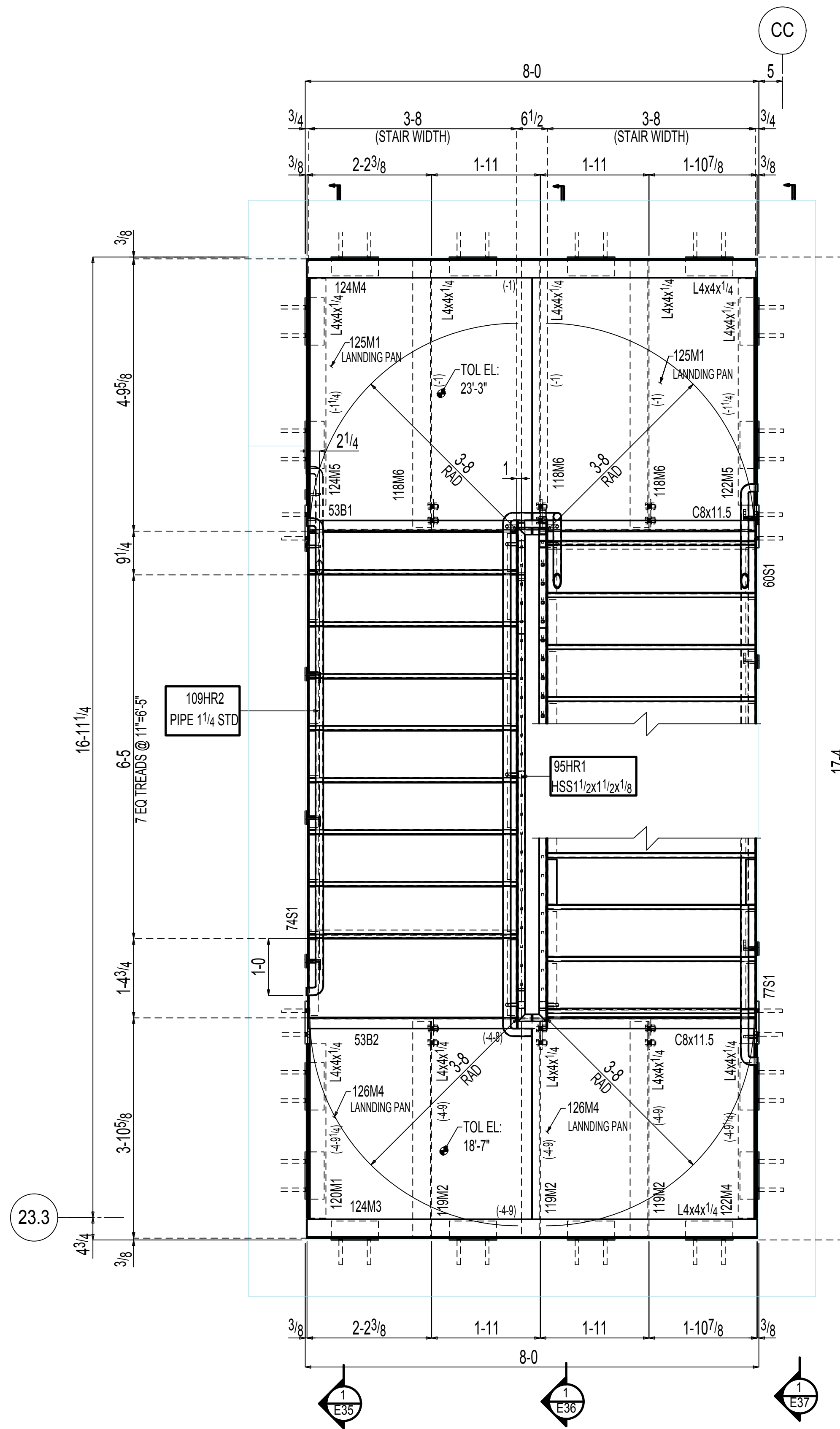

STAIR -1 PLAN

NOTES:
 1. TOP OF STEEL ELEVATION = (23-0) U.N.O.
 2. (+/- X-X) = ABOVE/BELOW TOP OF STEEL ELEVATION.

(REF DWG:A601)

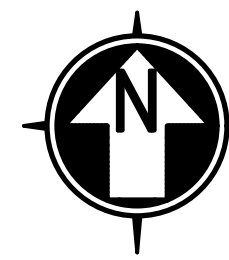
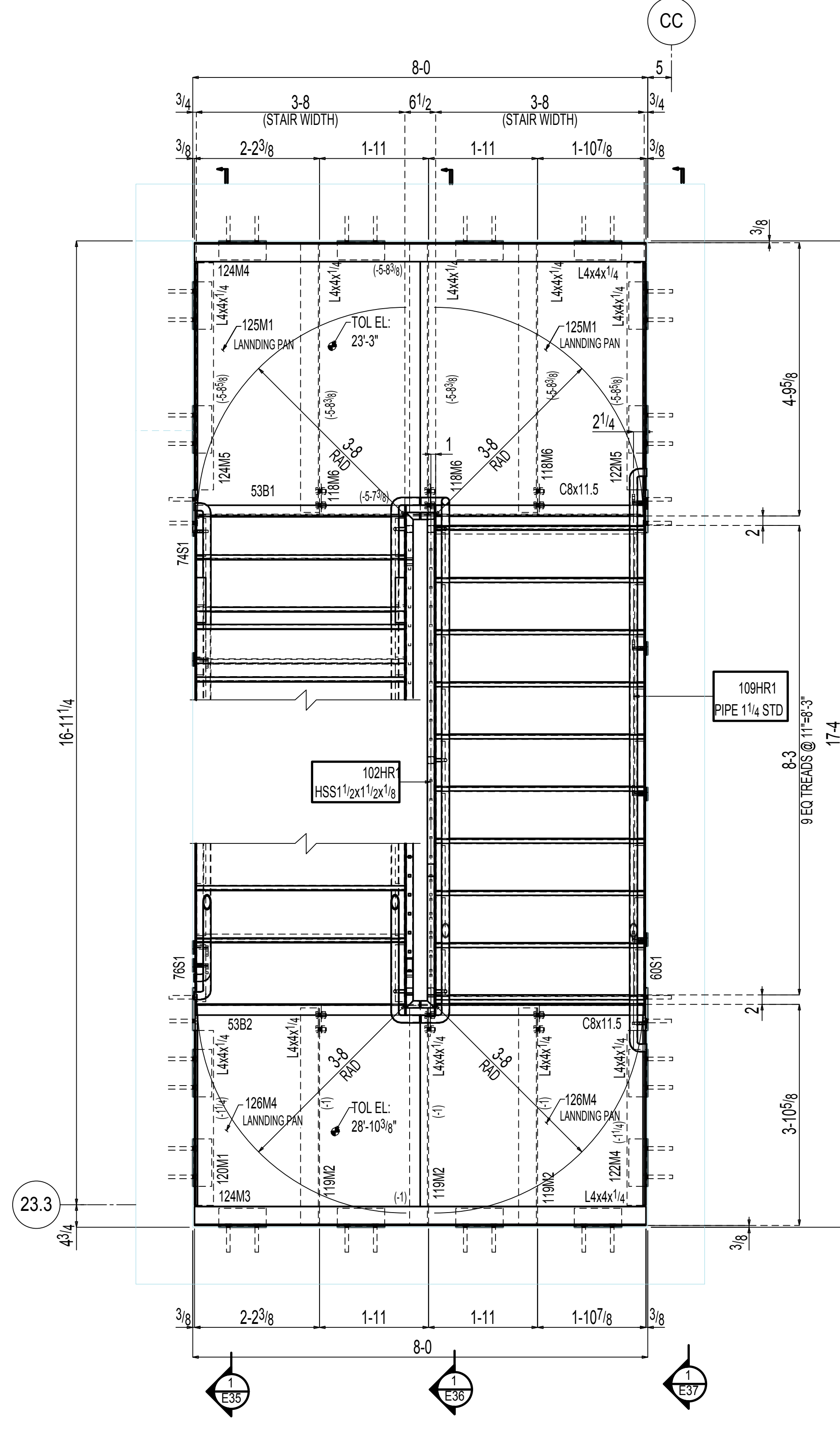

STAIR -1 PLAN

NOTES:
 1. TOP OF STEEL ELEVATION = (28-7³/₈) U.N.O.
 2. (+/- X-X) = ABOVE/BELOW TOP OF STEEL ELEVATION.

(REF DWG:A601)

23.3

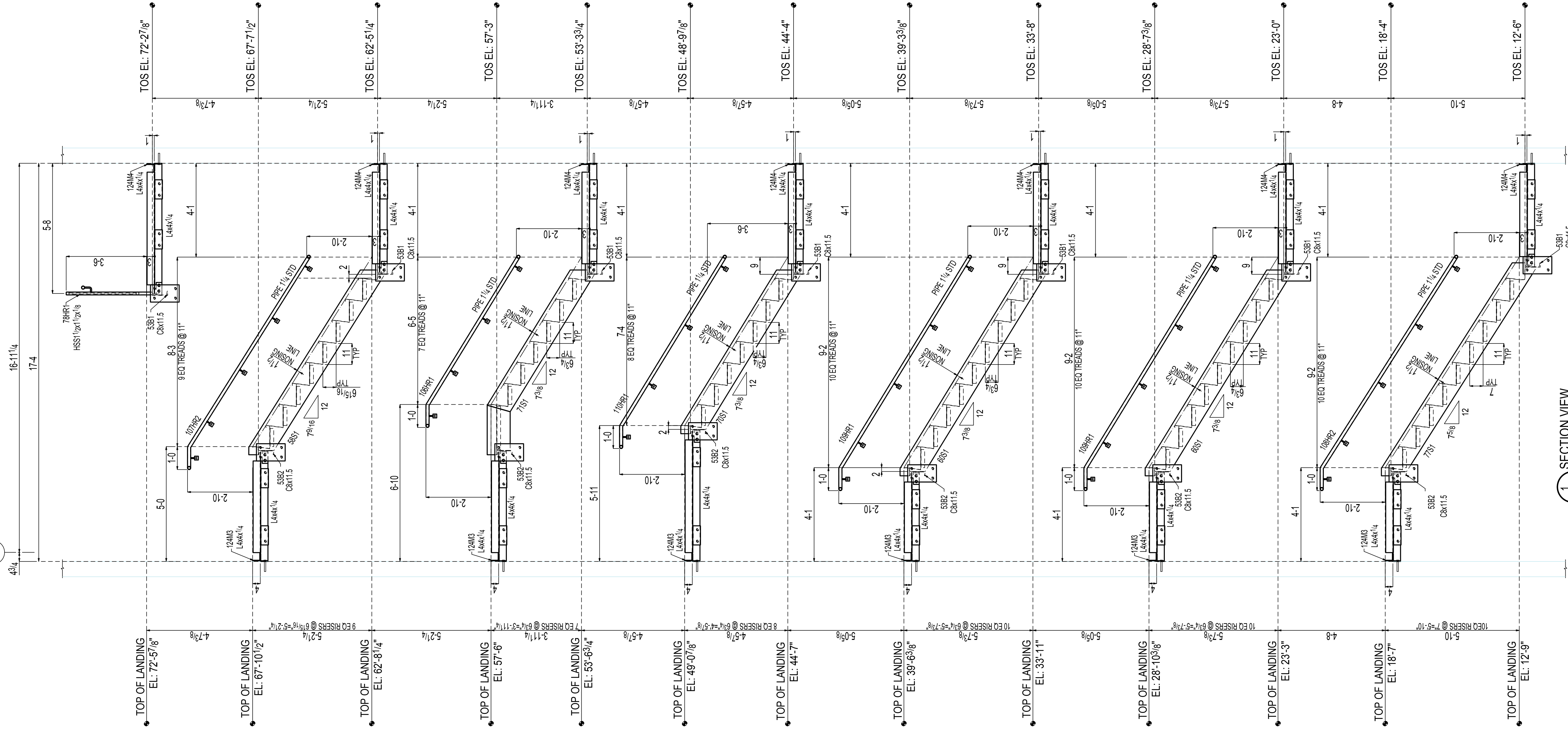

1 SECTION VIEW
E37